

R&D

FRIDENSON Engineering Ltd.

Phone: 972-3-5591563

Web site: www.fridenson-eng.co.il

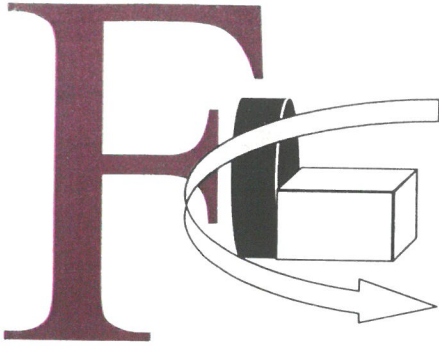

BUREAU VERITAS
Certification

Certification
awarded to:

FRIDENSON ENGINEERING LTD.
12 HANAPAH ST., HOLON 58118, ISRAEL

Bureau Veritas Certification certifies that the Management System of the above organization has been audited and found to be in accordance with the requirements of the management system standard detailed below:

Standard
ISO 9001: 2015

Scope of supply
HIGH PRECISION CNC MACHINING / WORKS & SALES OF GEOMETRICAL PLASTIC RAW MATERIALS, PROCESSING & ASSEMBLY OF PLASTIC BOARDS

Valid from the date: **13 JUNE 2004**

Valid until the date: **29 MAY 2009**

For more information contact us at: **072 3 93 13 566**

Valid until the date: **19 JUNE 2009**

Certification Number: **21956GA**

Place of Issue: **United Kingdom**

ISO 9001:2015 Certified Quality System

IQC
Institute of Quality & Control

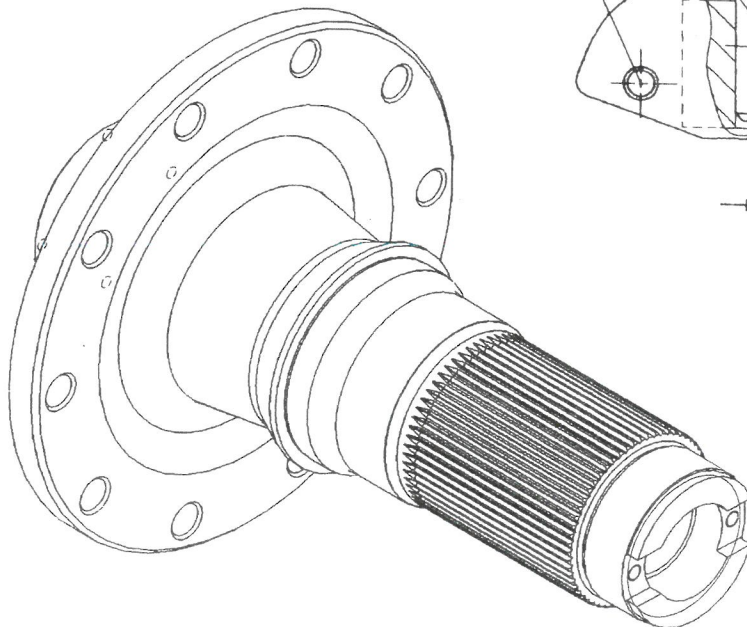
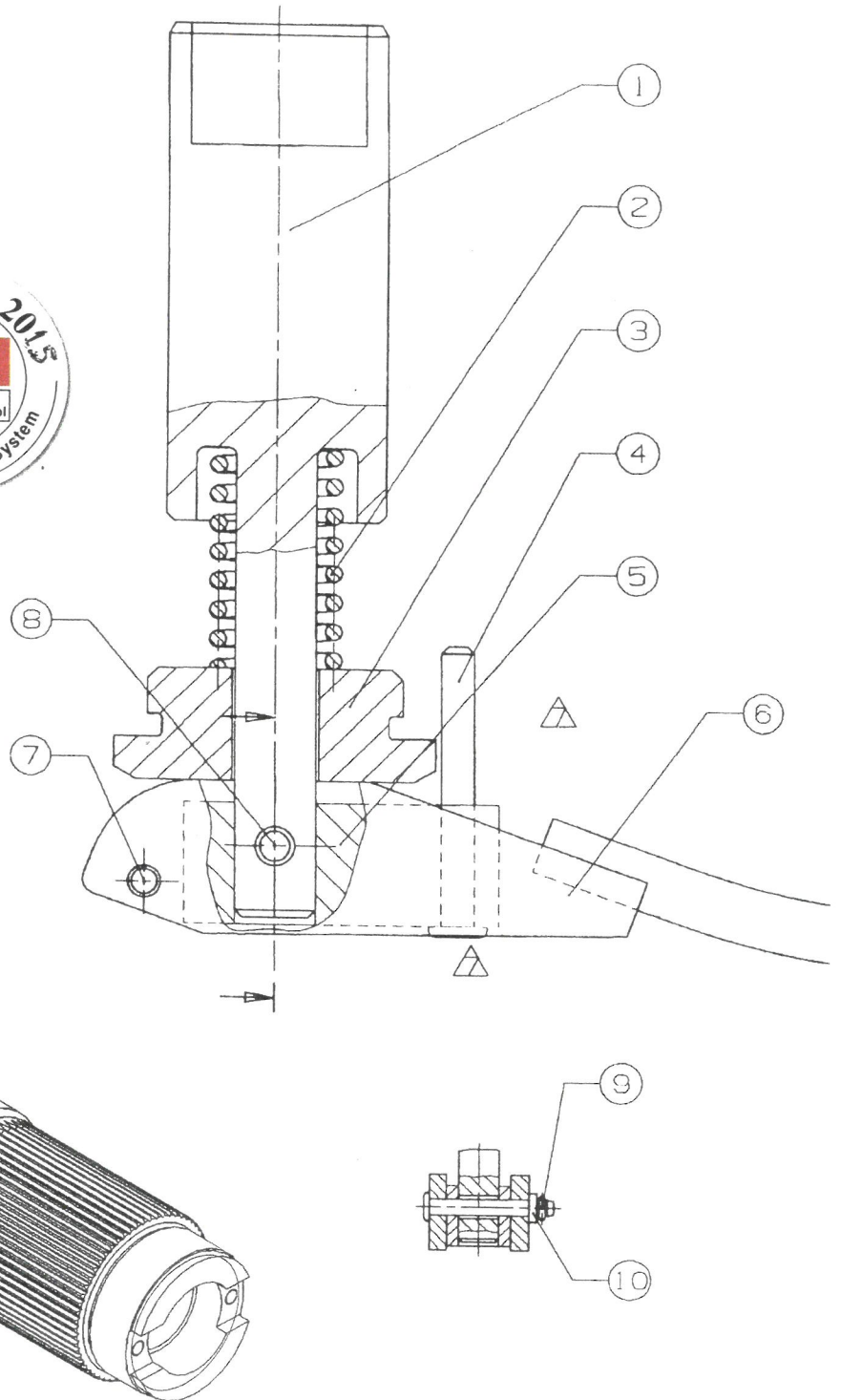

UNLESS OTHERWISE SPECIFIED:

DIMENSIONS ARE IN INCHES
TOLERANCES:
FRACTIONAL ±
ANGULAR: MACH ± BEND ±
TWO PLACE DECIMAL ±
THREE PLACE DECIMAL ±

INTERPRET GEOMETRIC TOLERANCING PER:

MATERIAL **SAE 4340**
FINISH **BLACK OXIDE**

DO NOT SCALE DRAWING

DRAWN
CHECKED
ENG APPR.
MFG APPR.
Q.A.

NAME **VERA**

DATE **15/4/08**

COMMENTS:

P.N
010557453

FRIDENSON ENG. LTD.

TITLE:

SHAFT GENERAL VIEW FRONT

SIZE DWG. NO.

A MZ-0508-1

SCALE: 1:10 WEIGHT:

REV

00

SHEET 1 OF 5

PROPRIETARY AND CONFIDENTIAL
THE INFORMATION CONTAINED IN THIS DRAWING IS THE SOLE PROPERTY OF «INSERT COMPANY NAME HERE». ANY REPRODUCTION IN PART OR AS A WHOLE WITHOUT THE WRITTEN PERMISSION OF «INSERT COMPANY NAME HERE» IS PROHIBITED.

MZ-0506

NEXT ASSY

USED ON

APPLICATION

FRIDENSON Engineering Ltd.
12 Hanapach St., Holon ISRAEL
T 0972-3-5591563, Fax. 5567620

"פרידנזון"
מתכת והנדסה בע"מ

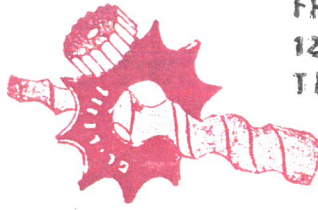

אספקת חמרי גלם פלסטיים הנדסיים

הננו מציעים בזאת
אספקת חמרי גלם שונים
מפלסטיק ע"פ הגדרה
הנדסית או מסחרית
כולל אישורי C.O.C.
כנדרש:

- ❖ פלטות עד 160 מ"מ עובי
- ❖ מוטות מלאים
- ❖ עד קוטר 750 מ"מ
- ❖ מוטות חלולים
- ❖ עד קוטר 900 מ"מ (קוטר חיצוני)

מוצרים מוצגים
בתערוכת
MÉTAL



כמו כן אנו מבצעים פרויקטים הקשורים בחומרים
אלו הכוללים תכנון ויעוץ הנדסי.

תשומת לבכם לחמרי הגלם החדשים: פוליאמיד – PAGG
וארטלייט – PETP

אספקה מהירה ומחירים אטרקטיביים

"פרידנזון" רחוב הנפח 12, חולון 58818 טלפון: 5591563 פקס: 03-5567620

חמרי גלם פלסטיים הנדסיים - נתונים טכניים

להלן נתונים טכניים פיסיקליים, מכאניים, חשמליים תרמיים והמלצה לשימושים של ח"ג פלסטיים הנדסיים המצויים באורח שוטף במלאי:

Material	Specific Gravity gr/cm ³	Moisture Absorbion In Air %	Color	Tensil Stress N/mm ²	Coefficient of Friction to Steel Dry	Coefficient of Friction to Wear	Volume Resistivity ohm#cm	Dielectric Factor	Flammability UL 94	Continuous Operating Temperature in Air	Price compared To Pom=1
PVC	1.4	0.2	white / black / gray	55	0.6	56	1E+16	3	V0	60	0.47
ABS	1.06	0.4	gray	50	0.5	8.4	1E+15	3.3	HB	75	1.73
PE 500	0.95	0	green / white	26	0.3	1	1E+17	2.3	HB	80	0.44
PE 300	0.95	0	black / white	28	0.3	7.4	1E+17	2.3	HB	80	0.45
Acrylic	1.35	0.3	clear	72	0.55		1E+15	2.9	HB	80	7.19
NORYL	1.06	0.1	gray	55	0.4	90	1E+13	2.6	HB	85	1.84
NORYL GF30	1.29	0.05		105			1E+15	3.1	HB	85	2.53
PE-HD	0.96	0.05	white / green / black	25	0.29	7.4	1E+15	2.4	HB	90	0.49
PE 1000	0.93	0.01	white / green	40	0.25	0.45	1E+15	2.3	HB	90	0.89
OILAMID	1.11	2.5	natural	90	0.19	0.08	1E+12	3.3	HB	90	1.78
PP	0.91	0.1		30	0.3	11	1E+14	2.25	HB	100	0.46
PA 6	1.13	3	white / black	85	0.415	0.23	1E+13	5.35	HB	100	0.60
PA6G	1.15	2.5	white	85	0.4	0.1	5E+14	3.7	HB	100	0.66
PA6G MoS ₂	1.15	2.5	black	75		0.08	1E+14		HB	100	0.69
POM C	1.41	0.3	black / white	60	0.32	8.9	1E+14	3.5	HB	100	1.00
PA 66	1.14	2.85	black / natural	80	0.385	0.9	1E+12	4.3	V2	100	1.21
PET TX	1.44	0.1	gray	76		1.1	1E+15	3.4	HB	100	1.77
PA 6 GF30	1.35	2.1	black	140	0.49	4.6	3E+15	3.6	HB	100	2.16
PA 11	1.03	0.9	natural	40	0.35	0.8	1E+14	3.4	V2	100	3.57
PVC-C	1.55	0.2	gray	57			1E+15	3	V0	102	-
NEMA C	1.35		brown	80	0.4	3.6		5		110	1.15
PET	1.34	0.25	black / white	55	0.25	0.35	1E+13	3.2	HB	110	1.21
POM H	1.42	0.3	white	70	0.34	4.6	1E+14	3.7	HB	110	1.41
PA 12	1.01	0.7	natural	40	0.35	0.8	1E+14	3.35	V2	110	2.30
NEMA CE	1.35		brown	70				5		110	2.86
PA 66 GF30	1.35	1.5	black	160	0.475		1E+15		HB	110	2.95
POM AF	1.54	0.18	brown	50	0.14		1E+15	3.1	HB	110	8.86
NEMA LE	1.35		brown	80				5		110	-
X,XP	1.35		brown	120				5		120	0.82
PC	1.2	0.15	transfärer	60	0.55	22	1E+13	3	V2	120	1.72
FR 4	1.8		greeny	220				5		120	2.71
PC GF30	1.43	0.1	greeny	130			1E+16	3.3	V1	120	2.85
PBT GF30	1.53	0.15	white	135	0.24		1E+13	3.2	HB	120	3.44
G10	1.8		greeny	220				5		130	2.71
PA 46	1.18	3.7	brown	100	0.325		1E+15	5.25	V2	130	-
PVDF	1.77	0.05	natural	50	0.3		1E+14	8	V0	150	6.94
G11	1.8		greeny	220				5		155	3.55
PSU	1.78	0.2	clear brown	80	0.4		1E+16	3.1	V0	160	7.29
PEI	1.27	0.7	clear brown	105			1E+15	3.15	V0	170	3.45
G7	1.75		white	90				5		180	4.22
PES	1.37	0.7	clear brown	90			1E+16	3.5	V0	180	8.10
PPS GF 40%	1.65	0.02		185			1E+13	4	V0	230	9.63
VESPEL SP-1	1.43	1.2	natural	86			1E+16	3.6	V0	240	-
TORLON 4203 PAI	1.41	2.5	yellow	120			1E+17	4.2	V0	250	-
PTFE	2.18	0.05	white	25	0.09	21	1E+16	2.1	V0	260	5.29
PTFE GF25	2.22	0.05	white	17	0.18	1.3	1E+16	2.85	V0	260	7.10
PTFE GRAPHITE 15%	2.15	0.05	black	16	0.15	1	1000		V0	260	7.19
PEEK	1.32	0.1	brown	95	0.34		1E+16	3.25	V0	260	27.28
PEEK PVX	1.48	0.1	black	130	0.11				V0	260	35.59
PEEK GF30	1.49	0.1	brown	180	0.42		1E+16		V0	260	37.09
PEEK CF30	1.4	0.1	black	215					V0	260	-
DELTERM	1.85	0.2	silver	400						280	9.86
SINTIMID GRAPHITE 15%	1.42	2.3		97	0.27				V0	300	-
SINTIMID PI	1.35	2.6	black	116			1E+17	3.1	V0	300	-
PAMTHERM	2.3	0.5	silver	180						450	12.26
DOTHERM 600M	2.2	0.1	silver	120			1E+16	6.5	V0	600	-
"MACOR"	2.52		white	105			1E+16			1000	1713.15
ALUMINUM OXIDE	3.98		pink white	460				9.8			56.31
SILICON NITRIDE	3.3			930			1E+14	8.14			1952.38

FOR SALE / CHARTER

BENETEAU GT 46 – LUXURY YACHT



Condition: Excellent

Location: Cyprus

This exquisite Beneteau GT 46 is offered for sale or charter, including private cruises and events. Privately owned, meticulously maintained, and upgraded - featuring enlarged fuel tanks (1400 L) for extended cruising range.

Main Specifications:

- 2 x 435 HP Turbo Volvo Penta IPS-600 (870 HP total)
- Generator: Cummins Onan 75 B
- Fuel Capacity: 1400 L
- Total Berths: 7
- Air Conditioning: Full coverage - cabins, kitchen, saloon, cockpit



Currently docked in Cyprus

Captain Shlomo

Fridenson Eng Ltd

ShlomoFridenson@gmail.com

+972-50-5881179

a one day tour *WITH YACHT*

For up to 6 peoples which includes

Sea shores tour 3 hours

Two hours of sea swimming

One hour of fishing

Lunch in boat cooked

970 € total cost

Shlomo

Captain  of yacht Hita

+972 50 5881179

BENETEAU GT 46 – LUXURY YACHT

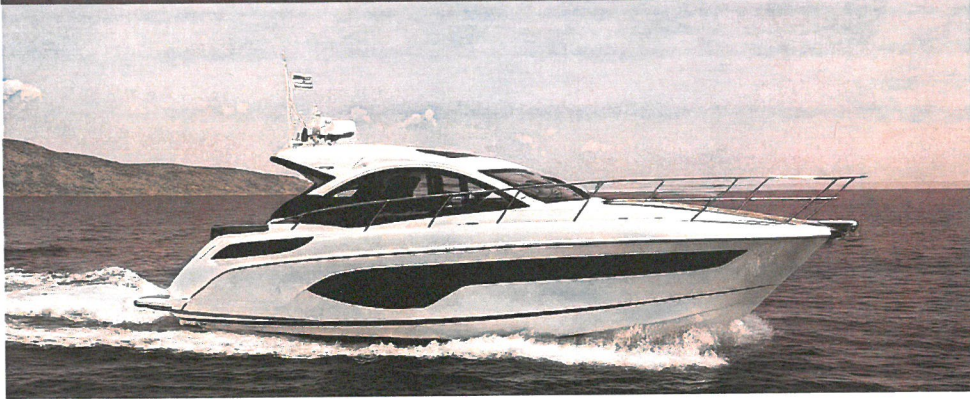

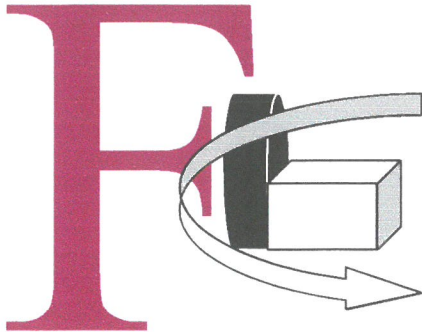

FRIDENSON

Engineering and Ballistic Protection

12 Hanapach st., Holon, Israel 5881806

Phone: 972-3-5591563 Fax: 972-3-5567620

www.fridenson-eng.co.il

Fridenson's Areas of Activity:

- Armoring Vehicles all around including windows protection against bullets of military rifles (standard nij 3+, en/br-5, en/br-6, ul 752, level 4-8).
- Light weighted Body Armor Protection Shields.
- Armored Podium.
- Armoring materials (Polythylene non woven, Kevlar rubberized, "Ceramic"- Alumina tiles & mono blocks).
- Arms spare parts manufacturing.
- Armored Shooting Port.

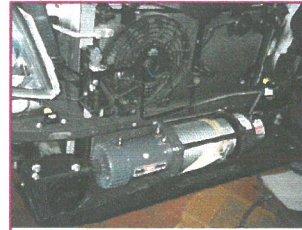

Armoring Vehicles winch

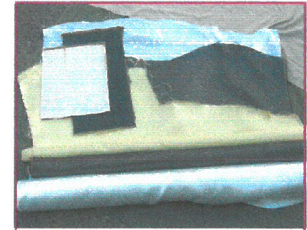

Composite materials



Armoring Vehicle Barrier



Armored Shooting Port

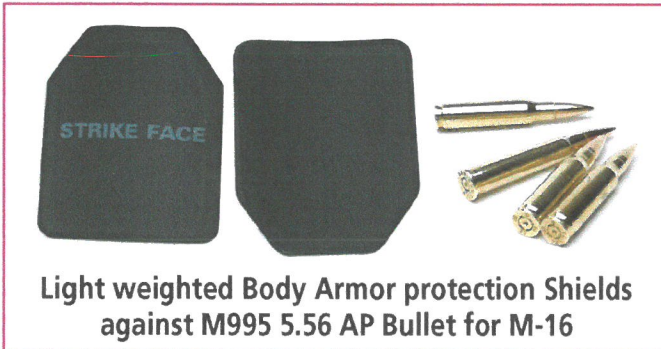

Light weighted Body Armor protection Shields against M995 5.56 AP Bullet for M-16



Armoring Vehicles

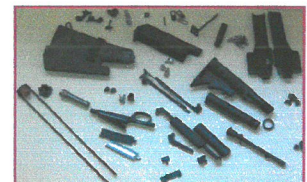

Arms Spare Parts



Vehicle Anti-wear, Anti-scratch & Unbreakable, Clear or Bronze Polycarbonate Windows against stones throwing

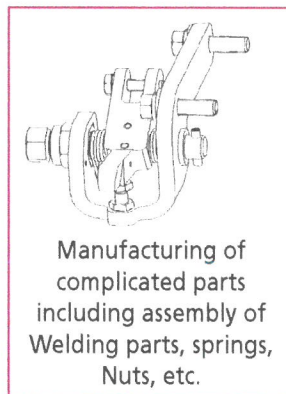

Manufacturing of complicated parts including assembly of Welding parts, springs, Nuts, etc.

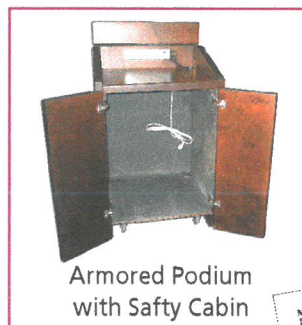

Armored Podium with Safty Cabin



Improved M-16 extension cover



Cannon Barrels cleaning & Oiling heads



Manufacturing Complicated Weapon parts

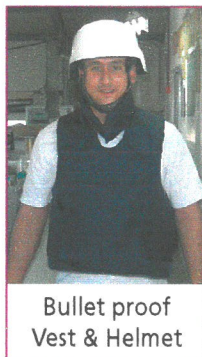

Bullet proof Vest & Helmet

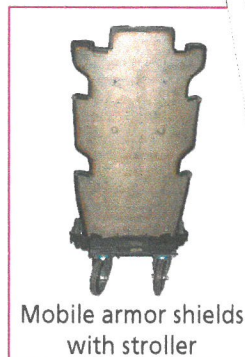

Mobile armor shields with stroller

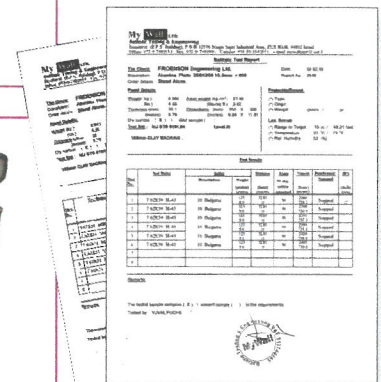

Ballistic Test Reports from a known lab

Approved ISO 9001-2015
 Approved supplier to Israeli Aircraft, Navy, Defense and Electronic Communication high-tech industries.

MUNITION SHELL CARTRIDGE MADE OF ENGINEERING ANTISTATIC PLASTIC MATERIALS

< Files

19-116-0...idge_asm 2

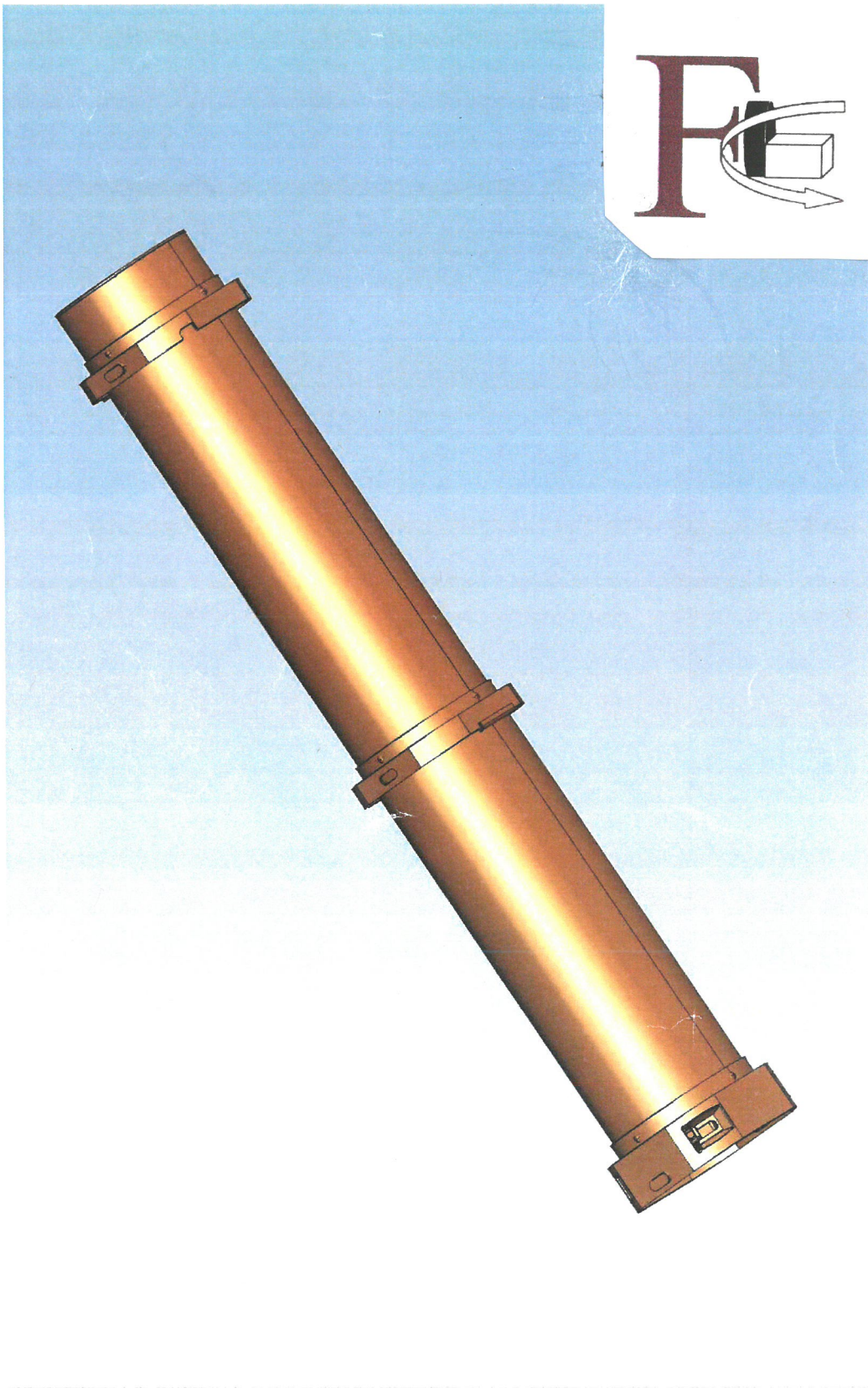

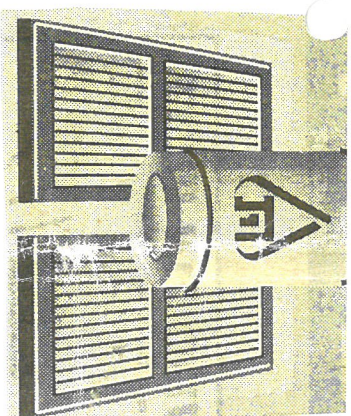

"בקר בקרן זרין"

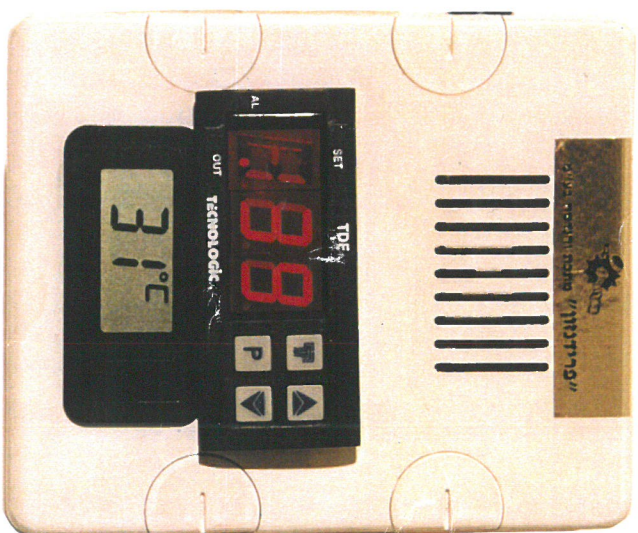

- בקר טמפרטורה ממוחשב למים חמים
- מתאים לדוד שמש ולדוד חשמלי
- נוה לתפעול
- אין צורך יותר לדאוג למים החמים
- שומר על רמת מים חמים רצויה
- אין צורך לחשוש מפני מים קרים בזמן הרחצה
- כאשר השמש מתממת הוא אינו מחמם
- לא מאפשר רתיחה של המים ובכך מונע היווצרות אבנית.
- חוסך אנרגיה - חוסך כסף
- התקנה פשוטה ע"י חשמלאי מוסמך או ע"י טכנאי
- חברת פרדינור.
- אחריית מלאה



רחוב הנפה 12, חולון 5888066 טלפון: 5591563